The background is a deep blue with a complex pattern of glowing, semi-transparent circles and lines of varying sizes and opacities, creating a sense of depth and movement. The text is centered in a bold, white, sans-serif font.

RAL/PPD PhD Studentship Practicalities

Ian Tomalin

RAL Particle Physics PhD Studentships

❖ RAL Particle Physics Dept. offers 6 funded PhD studentships starting in Autumn 2026:

- Project 1: "QUEST/Darkside: searching for Dark Matter beyond WIMPs with Novel Detector Technologies" (PPD/Oxford)
- Project 2: "Dark Matter, New Physics & Radioassay at the Boulby Mine" (PPD-Boulby/Edinburgh)
- Project 3: "Searching for Dark Matter in final states with low-momentum leptons at the ATLAS experiment at the LHC" (PPD/Liverpool)
- Project 4: "Multi-Parton Dynamics & Exotic Scalar Production in ATLAS at the HL-LHC" (PPD/Warwick)
- Project 5: "LHCb: measurement of the Unitarity Angle Alpha & Development of the Mighty Tracker Readout" (PPD/Glasgow)
- Project 6: "Commissioning/calibration of Hyper-Kamiokande's far detector & development of the experiment's first Neutrino Oscillation Measurement (PPD/Liverpool)

❖ Each studentship has partner university, as RAL can't award degrees.

- Student will be blessed with 2 supervisors (RAL + university)!

RAL Particle Physics PhD Studentships

❖ Each PhD is 3.5 years long, with typically:

- First 2 terms based at university for lectures/courses there.
- Then year based at RAL, including additional lectures.
- Then year away at experiment (e.g. CERN in Geneva).
- Then back to RAL to complete research & write up thesis.

❖ For each PhD place, the STFC funding agency issues a [PhD grant](#) to the partner university covering its "home fees" & a stipend for the student's living costs & expenses.
(The cost of this is met either solely by RAL/PPD, or shared between PPD & the university).

- If a candidate must pay the more expensive "overseas fees", and can't pay the difference in fees themselves, the university sometimes finds a solution, such as waiving its right to charge "overseas" fees, if the candidate is particularly impressive.

RAL/PPD PhD Open Day Schedule

Details (maps & Zoom links) in <https://indico.stfc.ac.uk/event/1771/overview>

❖ Morning in Conference Room 3 (CR3) in Building R61 [10-12am]:

- Presentations on the 6 PhD projects.

❖ Lunch in Conference Room 3 [12-1pm]:

- Sign up for afternoon tours of ATLAS + Darkside-20k clean room.
- Sign up sheet for taxis at the end of the day.

❖ Afternoon in PPD (R1 1st floor) [1-4pm]: Individual chats with supervisors in 6 small rooms.

- Each chat is 28 mins long + 2 mins transition time.
- 50% of time for you to ask questions to supervisors. 50% for them to get to know you.
- In free slots, go to PPD Exhibition Room to join Clean Room tour or to chat informally to current students/staff, or relax in Coffee Lounge.

❖ 4:05 + 4:35pm taxis to Didcot train station (if you request it during lunch break)

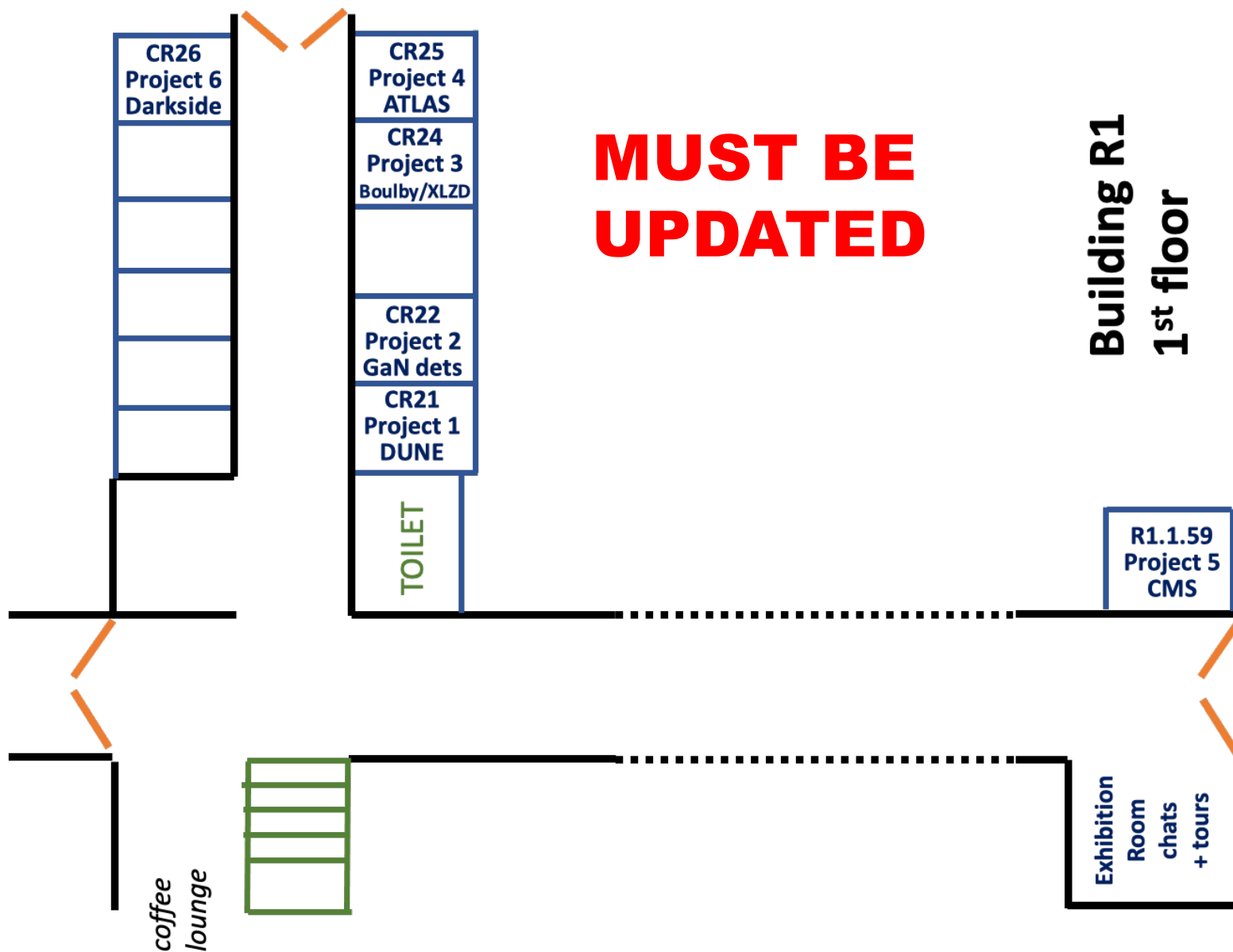

**MUST BE
UPDATED**

**Building R1
1st floor**

Schedule of afternoon chats (for students at RAL)

- ❖ The afternoon CHAT SCHEDULE between students & project supervisors is linked from the Open Day overview in indico.
- ❖ We've booked you chats for your 2 favourite projects (from your application form).
 - For very popular projects, we couldn't always do this.
 - If a 3rd project interests you, let me know during lunch, and we'll do our best to accommodate you.
- ❖ If a 3rd project catches your interest, we'll have additional chats via ZOOM in the days following the Open Day. You can each sign up for one of these chats as explained in indico.

Schedule of chats (remote students)

- ❖ Except in exceptional cases, there will be no ZOOM chats this afternoon.
- Instead, we'll have additional chats via ZOOM in the days following the Open Day. You can each sign up for 2 of these chats as explained in indico .
 - Wait until today is over before doing so, in case today changes your preferences.

After the Open Day & Chats

- ❖ All students list of all the PhD projects for which they wish to be considered, in decreasing order of preference in the **survey** that is linked from indico.
 - e.g. 3, 6, 2, 1, 5, 4.
- ❖ The supervisors of each project indicate which students they'd like to invite to formal interview.
- ❖ We assign of students to individual projects.
 - Student submits formal application to partner university (if not already done).
 - Formal interview of student with project supervisors (perhaps as part of university interviews)
 - Successful students will receive an offer from one (and only one) RAL/PPD PhD project.
- ❖ Students claim their travel expenses by submitting this [form](#) to PAPPDDIRECTOR@stfc.ac.uk, together with a single photo of all their receipts.